

State of California - The Resources Agency  
DEPARTMENT OF PARKS AND RECREATION

HISTORIC RESOURCES INVENTORY

(State use only)

Ser \_\_\_\_\_ Site \_\_\_\_\_ Mo. \_\_\_\_\_ Yr. \_\_\_\_\_  
 UTM \_\_\_\_\_ G \_\_\_\_\_ NR 4 SHL \_\_\_\_\_  
 Lat \_\_\_\_\_ Lon \_\_\_\_\_ Era \_\_\_\_\_ Sig \_\_\_\_\_  
 Adm \_\_\_\_\_ T2 \_\_\_\_\_ T3 \_\_\_\_\_ Cat \_\_\_\_\_ HABS \_\_\_\_\_ HAER \_\_\_\_\_ Fed \_\_\_\_\_  
 UTM 10/650283/4203112

IDENTIFICATION

1. Common name: Segarini House
2. Historic name, if known: -----
3. Street or rural address 1142, 1144, 1146 North San Joaquin Street  
 City: Stockton ZIP: 95202 County: San Joaquin
4. Present owner, if known: Guido Segarini Address: 2738 North Pacific Avenue  
 City: Stockton ZIP: 95204 Ownership is: Public  Private
5. Present Use: Apartments Original Use: Apartments  
 Other past uses: Unknown

DESCRIPTION

6. Briefly describe the present physical appearance of the site or structure and describe any major alterations from its original condition:

This 2 story Craftsman structure is located at 1142, 1146, 1146 North San Joaquin Street. It has a gabled roof with extended eaves, exposed rafters, bargeboards, vents and a gabled dormer. It has clapboard siding. First and second floor porches have square posts, windows have multipaned upper sashes. Concrete steps with brick railings are alterations. Several large trees obscure the view of the house.

7. Locational sketch map (draw and label site and surrounding streets, roads, and prominent landmarks):

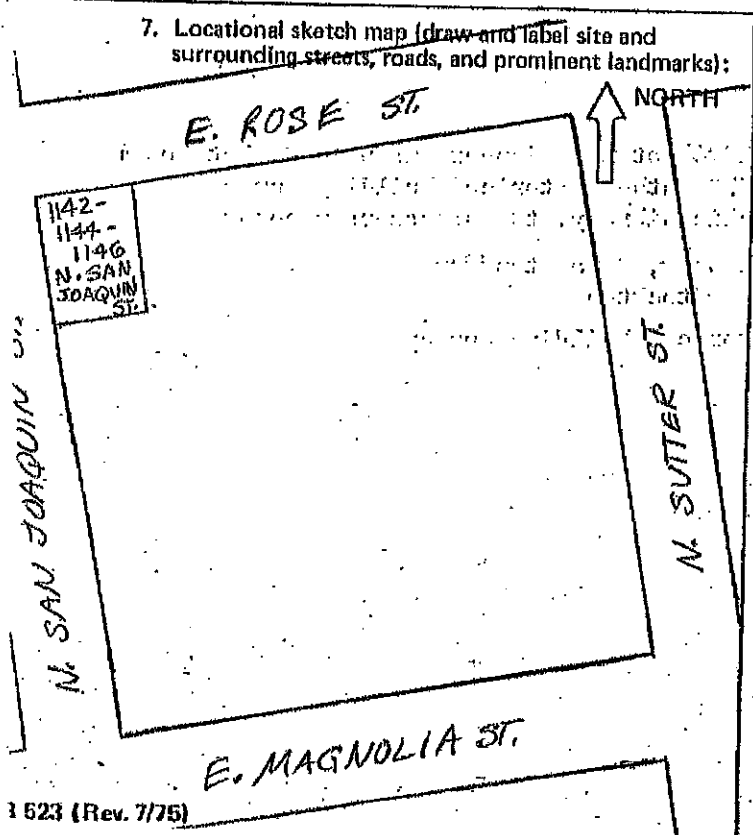

8. Approximate property size:  
 Lot size (in feet) Frontage 75  
 Depth 50  
 or approx. acreage .086
9. Condition: (check one)  
 a. Excellent  b. Good  c. Fair   
 d. Deteriorated  e. No longer in existence
10. Is the feature a. Altered?  b. Unaltered?
11. Surroundings: (Check more than one if necessary)  
 a. Open land  b. Scattered buildings   
 c. Densely built-up  d. Residential   
 e. Commercial  f. Industrial   
 g. Other
12. Threats to site:  
 a. None known  b. Private development   
 c. Zoning  d. Public Works project   
 e. Vandallism  f. Other
13. Date(s) of enclosed photographs: 10/77

NOTE: The following (Items 14-19) are for structures only.

14. Primary exterior building material: a. Stone  b. Brick  c. Stucco  d. Adobe  e. Wood   
 f. Other
15. Is the structure: a. On its original site?  b. Moved?  c. Unknown?
16. Year of initial construction 1918 This date is: a. Factual  b. Estimated
17. Architect (if known): Unknown
18. Builder (if known): Unknown
19. Related features: a. Barn  b. Carriage house  c. Outhouse  d. Shed(s)  e. Formal garden(s)   
 f. Windmill  g. Watertower/tankhouse  h. Other  garage i. None

SIGNIFICANCE

20. Briefly state historical and/or architectural importance (include dates, events, and persons associated with the site when known):

This large apartment stands out on its corner lot. Other large older houses are on the street. This one is zoned c-r. Large trees are on the street.

21. Main theme of the historic resource: (Check only one): a. Architecture  b. Arts & Leisure   
 c. Economic/Industrial  d. Exploration/Settlement  e. Government  f. Military   
 g. Religion  h. Social/Education

22. Sources: List books, documents, surveys, personal interviews, and their dates:

Plat Books (1869-1884) and Sanborn Maps (1883-1894) at the Pioneer Museum and Plat Books (1884-1920) and Sanborn Maps (1917, 1964, and 1972) at the Historical Building Survey Office City Directories (1912-1940) at the St. (current) at the City Hall Annex

23. Date form prepared: 1/8/80 By (name):  
445 West Weber Avenue  
 Address: (209) 462-5583  
 Phone: \_\_\_\_\_ Organi

(State Use Or

