

State of California — The Resources Agency  
DEPARTMENT OF PARKS AND RECREATION

# HISTORIC RESOURCES INVENTORY

## IDENTIFICATION

1. Common name: Smith House
2. Historic name, if known: -----
3. Street or rural address: 222 East Flora  
City: Stockton ZIP: 95202 County: San Joaquin
4. Present owner, if known: Clara Smith Address: Same  
City: Stockton ZIP: 95202 Ownership is: Public ☐ Private ☒
5. Present Use: Residence Original Use: Same  
Other past uses: Unknown

## DESCRIPTION

6. Briefly describe the present physical appearance of the site or structure and describe any major alterations from its original condition:

The structure at 222 East Flora Street is a Queen Anne-Style 2 story wooden frame house. It has a pyramidal roof, 2 square side bays, medium steep gables and louvered vents. "Alternating" shingle (fishscale and butt end) one-fourth the way down and around to the front of the house to a front angled bay. There is a medium steep pedimented gable over the bay, with "Y" angled stick work, and a louver. There are decorative brackets beneath the gable pediment. Another feature of this house is a rectangular glass transom above the door. The porch has a hip roof on attenuated columns curving to the east side of the structure with railings. It has a full basement.

7. Locational sketch map (draw and label site and surrounding streets, roads, and prominent landmarks):

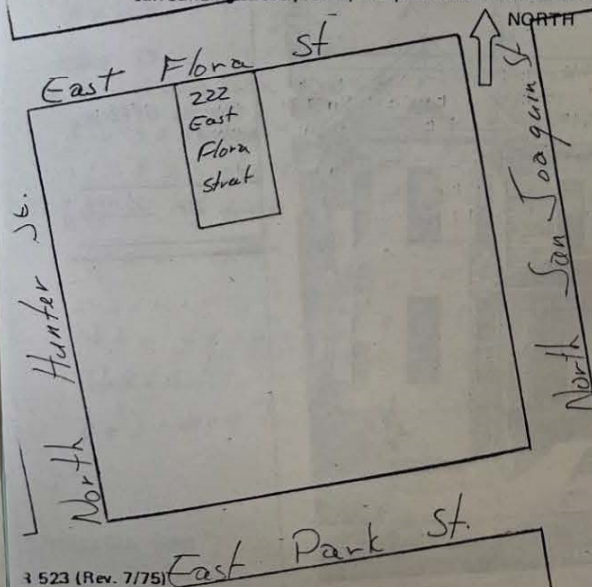

8. Approximate property size:  
Lot size (in feet) Frontage 50  
Depth 100  
or approx. acreage .115
9. Condition: (check one)  
a. Excellent ☐ b. Good ☒ c. Fair ☐  
d. Deteriorated ☐ e. No longer in existence ☐
10. Is the feature a. Altered? ☐ b. Unaltered? ☒
11. Surroundings: (Check more than one if necessary)  
a. Open land ☐ b. Scattered buildings ☐  
c. Densely built-up ☐ d. Residential ☒  
e. Commercial ☐ f. Industrial ☐  
g. Other ☐
12. Threats to site:  
a. None known ☒ b. Private development ☐  
c. Zoning ☐ d. Public Works project ☐  
e. Vandalism ☐ f. Other ☐
13. Date(s) of enclosed photograph(s): 8-177

NOTE: The following (Items 14-19) are for structures only.

14. Primary exterior building material: a. Stone ☐ b. Brick ☐ c. Stucco ☐ d. Adobe ☐ e. Wood ☒  
 f. Other ☐
15. Is the structure: a. On its original site? ☒ b. Moved? ☐ c. Unknown? ☐
16. Year of initial construction ca 1895 This date is: a. Factual ☐ b. Estimated ☒
17. Architect (if known): Unknown
18. Builder (if known): Unknown
19. Related features: a. Barn ☐ b. Carriage house ☐ c. Outhouse ☐ d. Shed(s) ☐ e. Formal garden(s) ☐  
 f. Windmill ☐ g. Watertower/tankhouse ☐ h. Other ☒ garage i. None ☐

## SIGNIFICANCE

20. Briefly state historical and/or architectural importance (include dates, events, and persons associated with the site when known):

This house was built for two sisters (the Keams) by their father who was a furniture store owner. It is located in a residential section of Stockton. This stately structure is on a block of similarly styled houses.

21. Main theme of the historic resource: (Check

c. Economic/Industrial ☐ d. Exploration ☐  
 g. Religion ☐ h. Social/Education ☐

22. Sources: List books, documents, surveys, etc.  
 Plat Books (1869-1881) and Sanborn  
 Maps (1884-1920) and Sanborn Maps (1917-  
 City Directories (1900-1939) at St  
 (current) at the City Hall Annex

23. Date form prepared: 11-28-79 By (name)  
 Address: 445 West Weber Avenue  
 Phone: (209) 462-5583

(State)



Lat Books  
 Survey Office,  
 records

eld  
 ZIP: 95203





LOG 3 NEG 8A-9

222 East Flora Street (1977)



222 East Flora Street (2025)