

ARCH AIRPORT ROAD STREET IMPROVEMENTS

STOCKTON, CALIFORNIA

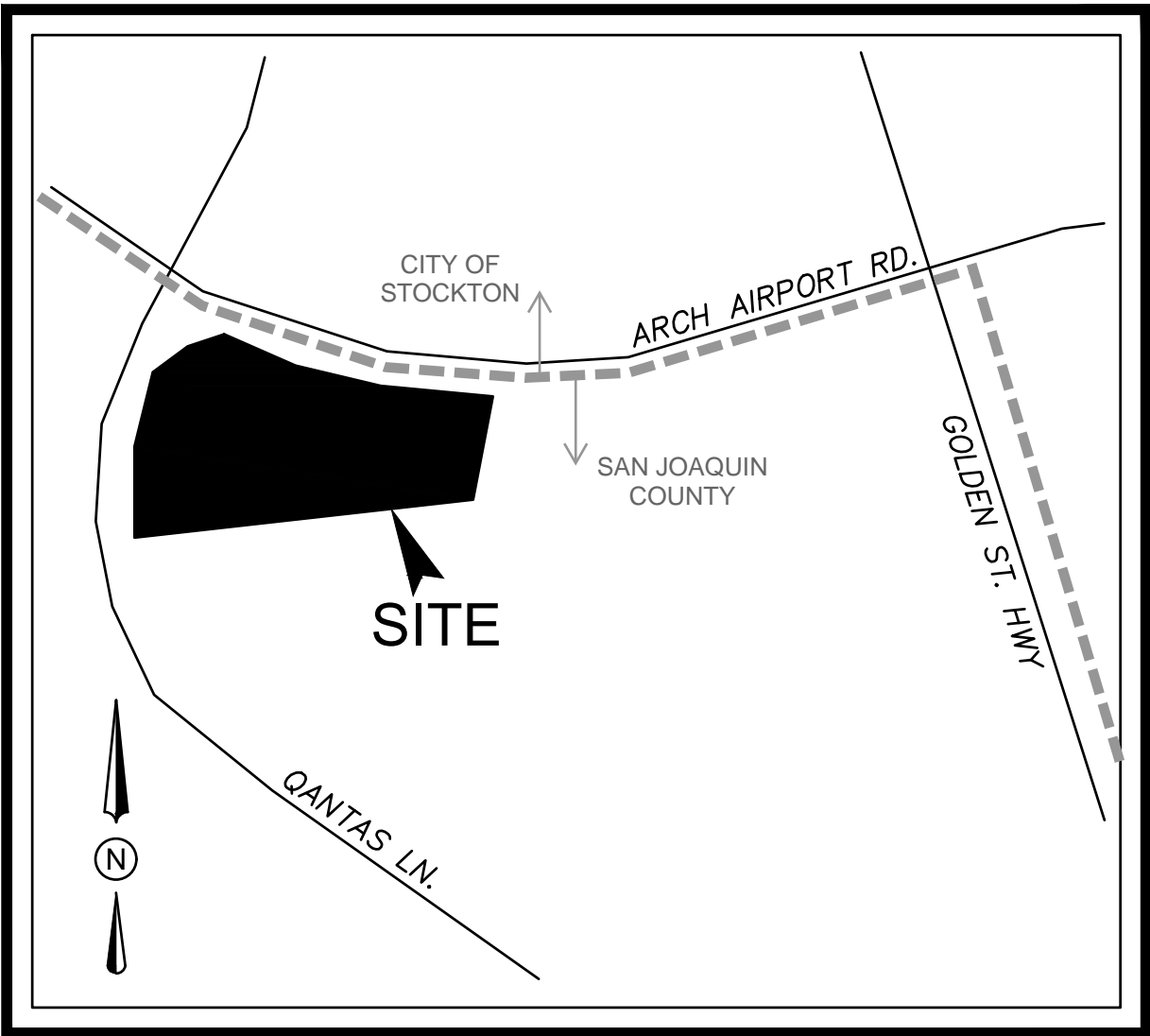

VICINITY MAP
N.T.S.

SITE LEGEND	
VERTICAL CURB & GUTTER	
SAW-CUT LINE	
SIGN	
RAMP	
TRAFFIC ARROW	
FIRE HYDRANT	
PROPOSED LIGHT POLE	

EXISTING LEGEND	
	BENCHMARK
	BOLLARD
	FIRE HYDRANT
	GUY POLE
	POWERPOLE
	SINGLE POLE SIGN
	STREET LIGHT
	TRAFFIC SIGNAL
	TRAFFIC SIGNAL BOX
	TREE-EVERGREEN
	TREE-MISC
	UTILITY POLE
	WATER METER
	WATER VALVE
	CHAIN LINK FENCE
	WOOD FENCE
	OHE
	OVERHEAD ELECTRIC

AGENCIES HAVING JURISDICTION

WATER:	CITY OF STOCKTON 425 N. EL DORADO ST STOCKTON, CA 95202 209.937.8436	GAS:	PACIFIC GAS & ELECTRIC 3136 BOEING WAY 95206 STOCKTON, CA 95206 209.272.8643
SEWER:	CITY OF STOCKTON 425 N. EL DORADO ST STOCKTON, CA 95202 209.937.8436	ELECTRIC:	PACIFIC GAS & ELECTRIC 3136 BOEING WAY 95206 STOCKTON, CA 95206 209.272.8643

OWNER		CIVIL / WATER	
COMPANY:	CITY OF STOCKTON 425 N. EL DORADO ST STOCKTON, CA 95202 209.937.8436	COMPANY:	SITE DESIGN COLLABORATIVE 243 E. 3RD STREET LONG BEACH, CA 90802
CONTACT:	PARVIZ CHITSAZAN PHONE: (209) 937-8243	CONTACT:	MEHDI KESHMIRI, P.E. MKESHMIRI@SDCOLLABORATIVE.COM 800-484-4717

SURVEYOR	
COMPANY:	BASE CONSULTING GROUP, INC. 1713 11TH STREET, SUITE 1 REEDLEY, CA 93654
CONTACT:	NEIL ELLIOTT THONSEN, PLS. 559.637.1544

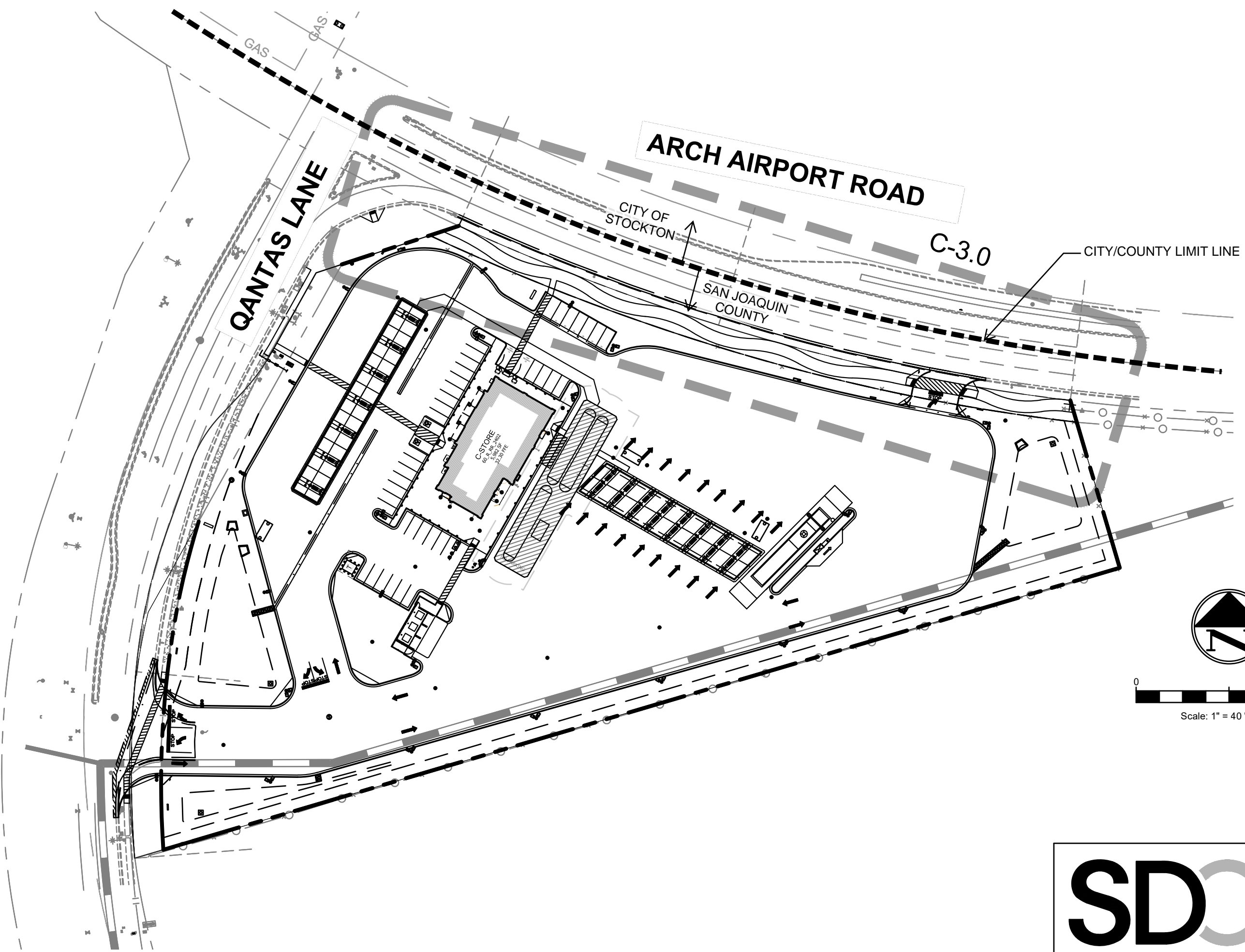

SHEET INDEX		
SHEET NO.	REF. NO.	SHEET DESCRIPTION
1	C-1.0	COVER SHEET
2	C-1.1	GENERAL NOTES
3	C-2.0	CROSS SECTIONS
4	C-3.0	CONSTRUCTION PLAN

BASIS OF ELEVATIONS:
CITY OF STOCKTON BENCHMARK NO. 334, BRASS DISK
STAMPED "11S-12" IN MONUMENT WELL.
ELEVATION = 32.43' NAVD88.

SITE BENCHMARKS:
BASE CONTROL POINT NUMBER 1.
NAIL SET IN CONCRETE MEDIAN AS SHOWN ON TOPO SHEET 2.
ELEVATION = 31.06'



<div><div>SDC</div><div>SITE DESIGN COLLABORATIVE</div></div> <div>243 E. 3rd Street Long Beach, CA 90802 1333 W. McDermott Dr., Suite 200 Allen, TX 75013 JOB NO.: 20240719.0 Firm # F-21415</div>					ARCH AIRPORT ROAD STREET IMPROVEMENTS			
					COVER SHEET			
REVISION NO.	DESCRIPTION	DATE	BY	APPRVD. BY	DEPARTMENT OF PUBLIC WORKS CITY OF STOCKTON, CALIFORNIA			
					SCALE:	AS NOTED	APPROVED BY: _____	SHEET NO.
					DESIGNED BY:	BB	DATE _____	C-1.0
					DRAWN BY:	BB	CITY ENGINEER STOCKTON, CALIFORNIA	OF 4 SHEETS
					CHECKED BY:	MK		PROJECT NO.
					RECORD DWG.:			

GENERAL NOTES

1. ALL IMPROVEMENTS SHALL BE CONSTRUCTED IN STRICT ACCORDANCE WITH THE FOLLOWING: THE CURRENT CITY OF STOCKTON STANDARD SPECIFICATIONS AND PLANS, AND ALL AMENDMENTS THERETO TO DATE, CALIFORNIA DEPARTMENT OF TRANSPORTATION STANDARD SPECIFICATIONS (CALTRANS) LATEST EDITION, WHERE APPLICABLE, AND CAMUTCD LATEST EDITION. WHERE THERE IS A CONFLICT BETWEEN THE PLANS AND THE CITY'S STANDARD SPECIFICATIONS AND PLANS, THE CITY OF STOCKTON STANDARD SPECIFICATION AND PLANS SHALL PREVAIL. ALL WORK SHALL BE SUBJECT TO INSPECTION BY THE CITY OF STOCKTON.
2. ELEVATIONS ARE REFERRED TO NAVD 88, 2011 DATUM CONVERSION, UNLESS NOTED OTHERWISE. REFER TO PLAN FOR BENCHMARK DESCRIPTIONS.
3. THE CITY OF STOCKTON STANDARD PLANS AND DETAILS AS SHOWN HEREON ARE FOR THE CONVENIENCE OF THE CONTRACTOR. PRIOR TO AND DURING CONSTRUCTION, THE CONTRACTOR SHALL BE RESPONSIBLE FOR BEING FAMILIAR WITH THE CURRENT CITY OF STOCKTON STANDARDS AND ALL UPDATES AND REVISIONS MADE TO ANY OF THE CITY OF STOCKTON STANDARD DETAILS SHOWN ON THESE PLANS. THE CONTRACTOR IS ALSO RESPONSIBLE FOR BEING FAMILIAR WITH THE WRITTEN SPECIFICATIONS AND/OR OTHER STANDARD DETAILS NOT SHOWN BUT WHICH ARE INCLUDED IN THE CITY OF STOCKTON STANDARD SPECIFICATIONS AND PLANS.
4. DRAWING NUMBERS SHOWN ON THE PLANS REFER TO CITY OF STOCKTON STANDARD PLANS, SHOWN THUS: DWG. NO. R-....
5. THE CONTRACTOR SHALL BE RESPONSIBLE FOR PROTECTING FROM DAMAGE ALL EXISTING IMPROVEMENTS THAT ARE TO REMAIN. SUCH IMPROVEMENTS THAT ARE DAMAGED BY THE CONTRACTOR SHALL BE REPLACED AT HIS EXPENSE.
6. EXCAVATION OF 5 FEET OR MORE IN DEPTH WILL REQUIRE AN EXCAVATION PERMIT FROM THE STATE OF CALIFORNIA DEPARTMENT OF INDUSTRIAL SAFETY.
7. THE CONTRACTOR SHALL DEMOLISH, EXCAVATE, REMOVE AND DISPOSE OF ALL EXISTING CONCRETE CURB, GUTTER OR SIDEWALK, ASPHALT CONCRETE PAVING, AND DELETERIOUS MATERIAL AS REQUIRED TO CONSTRUCT THE CONTRACT WORK. ALL SUCH EXCESS MATERIAL GENERATED SHALL BE DISPOSED OF FROM THE SITE BY THE CONTRACTOR.
8. THE CONTRACTOR SHALL OBTAIN AN ENCROACHMENT PERMIT FOR ANY WORK DONE WITHIN THE RIGHT-OF-WAY, INCLUDING A TRAFFIC CONTROL PLAN CONSISTENT WITH THE CAMUTCD TO BE APPROVED BY THE CITY'S PUBLIC WORKS DEPARTMENT IN ADVANCE OF THE WORK, FROM THE CITY OF STOCKTON PUBLIC WORKS DEPARTMENT, AND NOTIFY THE CITY 3 WORKING DAYS IN ADVANCE OF STARTING ANY WORK TO BE ACCEPTED FOR OWNERSHIP AND MAINTENANCE BY THE CITY OF STOCKTON.
9. WORK IN PUBLIC RIGHT-OF-WAY IS SUBJECT TO THE APPROVAL AND ACCEPTANCE OF THE CITY OF STOCKTON PUBLIC WORKS DEPARTMENT.
10. EXISTING UTILITIES ARE SHOWN AS THEY ARE BELIEVED TO EXIST. THE OWNER AND THE ENGINEER DO NOT ACCEPT RESPONSIBILITY FOR THEIR ACCURACY. PRIOR TO COMMENCING ANY WORK, THE CONTRACTOR SHALL HAVE EACH UTILITY COMPANY ACCURATELY LOCATE IN THE FIELD THEIR MAINS AND SERVICE LINES. IT SHALL BE THE CONTRACTOR'S RESPONSIBILITY TO PROTECT ALL EXISTING UTILITIES.
11. ATTENTION IS CALLED TO: SECTION 1540 (A) (1) (1) OF THE CONSTRUCTION SAFETY ORDERS (TITLE 8 CALIFORNIA ADMINISTRATION CODE SECTION 1540), ISSUED BY THE OCCUPATIONAL SAFETY AND HEALTH STANDARDS BOARD PURSUANT TO THE CALIFORNIA OCCUPATIONAL SAFETY AND HEALTH ACT OF 1973, AS AMENDED, WHICH STATES: "PRIOR TO OPENING AN EXCAVATION, EFFORT SHALL BE MADE TO DETERMINE WHETHER UNDERGROUND INSTALLATION I.E., SEWER, WATER, FUEL, ELECTRIC LINES, ETC., WILL BE ENCOUNTERED AND, IF SO, WHERE SUCH UNDERGROUND INSTALLATIONS ARE LOCATED. WHEN THE EXCAVATION APPROACHES THE APPROXIMATE LOCATION OF SUCH AN INSTALLATION, THE EXACT LOCATION SHALL BE DETERMINED BY CAREFUL PROBING OR HAND DIGGING AND WHEN IT IS UNCOVERED, ADEQUATE PROTECTION SHALL BE PROVIDED FOR THE EXISTING INSTALLATION. ALL KNOWN OWNERS OF UNDERGROUND FACILITIES IN THE AREA CONCERNED SHALL BE ADVISED OF PROPOSED WORK AT LEAST 48 HOURS PRIOR TO THE START OF ACTUAL EXCAVATION."
12. THE CONTRACTOR SHALL CONTACT THE PROJECT MANAGER OF THE CITY OF STOCKTON FOR A PRE-CONSTRUCTION CONFERENCE A MINIMUM OF THREE (3) WORKING DAYS PRIOR TO THE COMMENCEMENT OF WORK.
13. PRIOR TO COMMENCING ANY WORK, IT SHALL BE THE CONTRACTOR'S RESPONSIBILITY TO HAVE EACH UTILITY COMPANY LOCATE IN THE FIELD THEIR MAIN SERVICE LINES. THE CONTRACTOR SHALL NOTIFY MEMBERS OF THE UNDERGROUND SERVICE ALERT (U.S.A.) 48 HOURS IN ADVANCE OF PERFORMING EXCAVATION WORK BY CALLING THE TOLL-FREE NUMBER (800-227-2600).
14. THE CONTRACTOR SHALL CHECK WITH THE UTILITY COMPANIES AND VERIFY ALL UTILITY LOCATIONS. IT SHALL BE CONTRACTOR'S SOLE RESPONSIBILITY TO PROTECT ALL EXISTING UTILITIES SO THAT NO DAMAGE RESULTS TO THEM DURING THE PERFORMANCE OF HIS CONTRACT. THE CONTRACTOR SHALL BE REQUIRED TO COOPERATE WITH OTHER CONTRACTORS AND UTILITY COMPANIES INSTALLING NEW STRUCTURES, UTILITIES AND SERVICES TO THE DEVELOPMENT.
15. THE CONTRACTOR SHALL EXPOSE EXISTING STORM DRAINS AND SANITARY SEWERS WHERE CONNECTIONS ARE TO BE MADE SO EXISTING FLOWLINES AND LOCATIONS CAN BE VERIFIED BEFORE THE START OF CONSTRUCTION.
16. THE CONTRACTOR AGREES THAT HE SHALL ASSUME SOLE AND COMPLETE RESPONSIBILITY FOR JOBSITE CONDITIONS DURING THE COURSE OF CONSTRUCTION OF THIS PROJECT INCLUDING SAFETY OF ALL PERSONS AND PROPERTY, THAT THIS REQUIREMENT SHALL APPLY CONTINUOUSLY AND NOT BE LIMITED TO NORMAL WORKING HOURS, AND THAT THE CONTRACTOR SHALL DEFEND, INDEMNIFY AND HOLD THE OWNER AND THE ENGINEER HARMLESS FROM ANY AND ALL LIABILITY, REAL OR ALLEGED, IN CONNECTION WITH THE PERFORMANCE OF WORK ON THIS PROJECT, EXCEPTING FOR LIABILITY ARISING FROM THE SOLE NEGLIGENCE OF THE OWNER OR THE ENGINEER.
17. CONSTRUCTION STAKING: IF SDC, INC. IS NOT PERFORMING THE CONSTRUCTION STAKING, AND AN ERROR OR OMISSION ON THE PLANS IS DISCOVERED BY THE SURVEYOR PERFORMING THE CONSTRUCTION STAKING DURING THE PREPARATION OF THE STAKING PLAN AND IT IS NOT IMMEDIATELY BROUGHT TO THE ATTENTION OF SDC, INC. THEN SDC, INC. CANNOT, AND WILL NOT, TAKE RESPONSIBILITY FOR THE CONSTRUCTION COSTS HAD THE ERROR OR OMISSION BEEN MITIGABLE PRIOR TO CONSTRUCTION
18. THE CONTRACTOR SHALL OBTAIN A PERMIT FROM THE CALIFORNIA WATER SERVICE COMPANY OR THE CITY OF STOCKTON DEPENDING ON JURISDICTION FOR USE OF WATER FROM FIRE HYDRANTS FOR CONSTRUCTION PURPOSES. THE PERMIT SHALL BE APPROVED BY THE CITY OF STOCKTON FIRE DEPARTMENT.
19. THE PROPERTY OWNERS, DEVELOPERS, AND/OR SUCCESSORS IN INTEREST SHALL COMPLY WITH THE PROVISIONS OF THE CALIFORNIA GENERAL CONSTRUCTION ACTIVITY STORM WATER PERMIT AND STATE WATER RESOURCES CONTROL BOARD ORDER NUMBER 2009-0009-DWG, AS AMENDED BY 2010-0014-DWG. COMPLIANCE IS MANDATORY PER CHAPTER 15, SECTIONS 15.48.010 THROUGH 15.48.140 OF THE STOCKTON MUNICIPAL CODE.
20. DUST CONTROL SHALL BE PERFORMED AT ALL TIMES, AT THE CONTRACTORS' EXPENSE, TO MINIMIZE ANY DUST NUISANCE AND SHALL BE IN ACCORDANCE WITH SECTION 10 OF CALTRANS STANDARD SPECIFICATIONS AND THE REQUIREMENTS OF THE CITY OF STOCKTON.
21. THE CONTRACTOR SHALL FURNISH, INSTALL OPERATE AND MAINTAIN ALL MACHINERY,



- APPLIANCES AND EQUIPMENT TO MAINTAIN ALL EXCAVATIONS FREE FROM WATER DURING CONSTRUCTION, AND SHALL DEWATER AND DISPOSE OF THE WATER SO AS TO NOT CAUSE INJURY TO PUBLIC OR PRIVATE PROPERTY, OR TO CAUSE A NUISANCE OR MENACE TO THE PUBLIC. THE DEWATERING SYSTEM SHALL BE INSTALLED AND OPERATED SO THE GROUNDWATER LEVEL OUTSIDE THE EXCAVATION IS NOT REDUCED TO THE EXTENT WHICH WOULD CAUSE DAMAGE OR ENDANGER ADJACENT STRUCTURES OR PROPERTY. ALL COSTS FOR DEWATERING SHALL BE INCLUDED IN THE UNIT PRICE BID FOR ALL PIPE CONSTRUCTION. THE STATIC WATER LEVEL SHALL BE DRAWN DOWN A MINIMUM OF 1 FOOT BELOW THE BOTTOM OF EXCAVATION OF ANY FILL TO THE SPECIFIED DENSITY. DISPOSAL OF WATER SHALL BE IN ACCORDANCE WITH THE APPROVED SWPPP AND SHALL NOT DAMAGE PROPERTY. CREATE A PUBLIC NUISANCE OR VIOLATE THE LAW. THE CONTRACTOR SHALL HAVE ON HAND, PUMPING EQUIPMENT AND MACHINERY IN GOOD WORKING CONDITION FOR EMERGENCIES AND SHALL HAVE WORKMEN AVAILABLE FOR ITS OPERATION. THE DEWATERING SYSTEM SHALL OPERATE CONTINUOUSLY UNTIL BACK-FILL HAS BEEN COMPLETED TO 1 FOOT ABOVE THE NORMAL STATIC GROUNDWATER LEVEL.
22. UTILIZE A SEDIMENTATION OR FILTERING CONTROL MEASURE TO REMOVE SEDIMENT FROM DEWATERING WATERS PRIOR TO DISCHARGE. SEE SEDIMENT FILTER DETAIL ON THE EROSION CONTROL PLAN.
23. THE DISCHARGE OF CHLORINATED AND DE-CHLORINATED WATER INTO THE STORM DRAIN SYSTEM IS PROHIBITED. THE DISCHARGE OF CHLORINATED AND DE-CHLORINATED WATER INTO THE SANITARY SEWER SYSTEM REQUIRES PRIOR APPROVAL FROM MUD. CONTACT MUD AT 209-937-8341.
24. LOCATION OF SAW CUTTING AS REPRESENTED ON THESE PLANS SHALL BE DETERMINED IN THE FIELD WITH THE PUBLIC WORKS INSPECTOR. IF THE EXISTING SECTION REQUIRES GRINDING OR OVERLAYING OF AC, IT SHALL BE DETERMINED IN THE FIELD WITH THE PUBLIC WORKS INSPECTOR.
25. THE CONTRACTOR SHALL PROVIDE ALL LIGHTS, BARRICADES, SIGNS, FLAGMEN OR OTHER DEVICES NECESSARY FOR PUBLIC SAFETY.
26. THE CONTRACTOR SHALL BE HELD RESPONSIBLE FOR ANY FIELD CHANGES MADE WITHOUT PRIOR WRITTEN AUTHORIZATION FROM THE OWNER AND THE CITY ENGINEER.
27. WHENEVER EXISTING FACILITIES ARE REMOVED, DAMAGED, BROKEN OR CUT IN THE INSTALLATION OF THE WORK COVERED BY THESE PLANS OR SPECIFICATIONS, SAID FACILITIES SHALL BE REPLACED AT THE CONTRACTOR'S EXPENSE, AFTER PROPER BACKFILLING AND/OR CONSTRUCTION, WITH MATERIALS EQUAL TO OR BETTER THAN THE MATERIALS USED IN THE ORIGINAL EXISTING FACILITIES. THE FINISHED PRODUCT SHALL BE SUBJECT TO THE APPROVAL OF THE OWNER, THE ENGINEER, AND THE RESPECTIVE REGULATORY AGENCY.
28. THE CONTRACTOR SHALL MAINTAIN A NEATLY MARKED SET OF FULL-SIZE AS-BUILT RECORD DRAWINGS SHOWING THE FINAL LOCATION AND LAYOUT OF ALL MECHANICAL, ELECTRICAL AND OTHER INSTRUMENTATION EQUIPMENT, PIPING AND CONDUITS, STRUCTURES AND OTHER FACILITIES. THE AS-BUILTS OF THE ELECTRICAL SYSTEM SHALL INCLUDE THE STREET LIGHT LAYOUT PLAN SHOWING LOCATION OF LIGHTS, CONDUITS, CONDUCTORS, POINTS OF CONNECTIONS TO SERVICES, PULLBOXES, AND WIRE SIZES. AS-BUILT RECORD DRAWINGS SHALL REFLECT CHANGE ORDERS, ACCOMMODATIONS, AND ADJUSTMENTS TO ALL IMPROVEMENTS CONSTRUCTED. WHERE NECESSARY, SUPPLEMENTAL DRAWINGS SHALL BE PREPARED AND SUBMITTED BY THE CONTRACTOR.
29. SEE PROJECT SPECIFICATIONS FOR SUBMITTAL REQUIREMENTS.
30. ALL SIDEWALKS AND FACILITIES HAVE BEEN DESIGNED TO MEET ADA REQUIREMENTS. IF ANY DESIGN ELEMENT IS FOUND TO BE NON-ADA COMPLIANT NOTIFY ENGINEER IMMEDIATELY FOR A SOLUTION.
31. THE CONTRACTOR SHALL REPLACE ANY PAVEMENT DELINEATORS OR TRAFFIC MARKINGS, AND ALL OTHER TRAFFIC CONTROL DEVICES REMOVED OR DAMAGED IN THE COURSE OF THIS WORK. PRIOR TO ANY NECESSARY REMOVAL, THE CONTRACTOR SHALL DOCUMENT THE TYPE AND LOCATION OF THE PAVEMENT DELINEATION / MARKINGS OR TRAFFIC CONTROL DEVICES
32. THE CONTRACTOR SHALL INSTALL A NEW TRAFFIC LOOP PER CITY OF STOCKTON STANDARD DRAWING NO. R-96. WHEN AN EXISTING TRAFFIC LOOP CONFLICTS WITH THE NEW IMPROVEMENTS. THE EXISTING TRAFFIC LOOP THAT IS IN CONFLICT SHALL BE DEMOLISHED AND PROPERLY DISPOSED OF. CONTACT THE CITY INSPECTOR TO COORDINATE. THE CONTRACTOR SHALL BE RESPONSIBLE FOR REPLACING ANY TRAFFIC LOOPS THAT ARE DAMAGED OR ARE OTHERWISE REMOVED DURING THE COURSE OF THIS WORK.
33. THE CONTRACTOR SHALL PROTECT ALL EXISTING LANDSCAPE AND IRRIGATION IMPROVEMENTS THAT ARE TO REMAIN. ALL DISTURBED LANDSCAPING AND IRRIGATION SHALL BE REPAIRED, AS NECESSARY, TO THE SATISFACTION OF THE CITY'S LANDSCAPE ARCHITECT.
34. CONTRACTOR SHALL PROVIDE A ONE (1) YEAR WARRANTY FOR ALL LABOR AND MATERIALS ASSOCIATED WITH INSTALLED PUBLIC IMPROVEMENTS.
35. THE CONTRACTOR SHALL DEMONSTRATE TO THE CITY OF STOCKTON PUBLIC WORKS O&M, MANUEL RODRIGUEZ (209-649-4666), THAT ALL IRRIGATION IN NEW CONSTRUCTION AREAS IS IN WORKING ORDER.
36. EXISTING BUBBLERS WITHIN TREE WELLS SHALL BE ABANDONED, AND THEIR LATERALS SHALL BE RECONNECTED TO THE MAIN IRRIGATION LINE. THESE LATERAL RECONNECTIONS SHALL BE PROTECTED THROUGHOUT THE NEW CONSTRUCTION.
37. WHEELCHAIR RAMPS GRADE BREAKS SHALL BE PERPENDICULAR TO THE DIRECTION OF THE RAMP RUN, PER CBC 11B-406.5.6.
38. COORDINATE WITH CITY INSPECTOR TO VERIFY PRIOR TO ABANDONING, RECONNECTING, OR COVERING ANY EXISTING IRRIGATION FOUND IN THE PROJECT AREA. EXISTING IRRIGATION MAINLINES AND LATERALS SHALL BE PROTECTED. REROUTE AS NECESSARY.
39. CONTRACTOR SHALL NOTIFY THE PROPERTY OWNER AT LEAST 72 HOURS BEFORE ANY DRIVEWAY (ACCESS) CLOSURE.
40. SURVEY MONUMENT PRESERVATION: PRIOR TO CONSTRUCTION, CONTRACTOR SHALL ENGAGE A LICENSED SURVEYOR TO PERFORM A PRE-CONSTRUCTION MONUMENT PRESERVATION SURVEY IN ACCORDANCE WITH SECTIONS 8771(b) OF THE BUSINESS AND PROFESSIONS CODE OF THE STATE OF CALIFORNIA. LOCATIONS OF EXISTING MONUMENTATION KNOWN TO THE ENGINEER THAT ARE WITHIN THE AREA OF PROJECT HAVE BEEN INDICATED ON THE PLANS FOR REFERENCE. AT THE COMPLETION OF CONSTRUCTION, BUT PRIOR TO FINAL APPROVAL OF THE IMPROVEMENTS, CONTRACTOR'S LICENSED SURVEYOR SHALL PERFORM A POST-CONSTRUCTION MONUMENT PRESERVATION SURVEY IN ACCORDANCE WITH SECTIONS 8771(c) AND 8771(d), AND, IF NECESSARY, FILE A RECORD OF SURVEY OR CORNER RECORD(S) IN ACCORDANCE WITH SECTION 8771(f)

SIGNAGE & STRIPING GENERAL NOTES

1. THE CONTRACTOR SHALL PROVIDE ALL LIGHTS, BARRICADES, SIGNS, FLAGMEN OR OTHER DEVICES NECESSARY FOR PUBLIC SAFETY.
2. THE CONTRACTOR SHALL SUBMIT A TRAFFIC CONTROL AND/OR DETOUR PLAN FOR APPROVAL BY THE CITY OF STOCKTON TRAFFIC ENGINEER PRIOR TO THE START OF CONSTRUCTION.
3. ALL PAVEMENT MARKINGS, STRIPING AND CROSSWALKS SHALL BE THERMOPLASTIC.
4. STRIPING AND PAVEMENT MARKINGS SHALL BE IN STRICT CONFORMANCE WITH THE CA-MUTCD (LATEST EDITION) AND THE SPECIAL PROVISIONS SECTION 84. PAVEMENT MARKINGS SHALL ALSO CONFORM TO THE CAL TRANS SPECIFICATIONS (LATEST EDITION) SECTION 84.
5. SIGNING SHALL CONFORM TO THE CA-MUTCD (LATEST EDITION) AND CALTRANS SPECIFICATIONS (LATEST EDITION) SECTION 82.
6. REMOVAL OF EXISTING PAVEMENT MARKINGS SHALL BE REMOVED BY GRINDING PER CAL TRANS STANDARDS SPECIFICATIONS SECTION 84-9.
7. CONTRACTOR SHALL INSTALL A BLUE REFLECTOR ON FIRE HYDRANT SIDE AT ALL FIRE HYDRANT LOCATIONS PER CA-MUTCD, SECTION 3B.11 AND FIGURE 3B-102.
8. THE CONTRACTOR SHALL NOTIFY THE ENGINEER A MINIMUM OF THREE (3) WORKING DAYS IN ADVANCE OF THE LAYOUT AND CAT-TRACKING OF THE PROPOSED IMPROVEMENTS. CAT-TRACKING TO BE APPROVED BY TRAFFIC ENGINEERING PRIOR TO FINAL ACCEPTANCE OF STRIPING AND PAVEMENT MARKINGS.
9. THE CONTRACTOR SHALL ENSURE THAT THE APPROPRIATE STRIPING AND PAVEMENT MARKINGS ARE IN PLACE AT ALL TIMES. TEMPORARY STRIPING AND/OR PAVEMENT MARKINGS SHALL BE INSTALLED TO REPLACE ANY EXISTING STRIPING OR MARKINGS WHICH HAVE BEEN REMOVED. ANY CONFLICTING STRIPING SHALL BE REMOVED IMMEDIATELY BY THE CONTRACTOR PRIOR TO REOPENING THE STREET TO TRAFFIC.
10. THE CONTRACTOR SHALL REMOVE ANY EXISTING SIGNS IN CONFLICT WITH THESE PLANS AS DIRECTED BY THE CITY TRAFFIC ENGINEER. EXISTING STRIPING AND MARKINGS IN CONFLICT WITH THESE PLANS SHALL BE REMOVED BY THE CONTRACTOR. PAVEMENT SHALL BE REPAIRED IF DAMAGED IN CONJUNCTION WITH REMOVAL OF MARKERS.
11. R30E (CA) "NO PARKING" SIGNS ARE TO BE INSTALLED AT A 45° ANGLE FACING DIRECTION OF TRAFFIC FLOW. SIGN SIZE SHALL BE 12" X 18" OR 18" X 24"
12. ALL DIMENSIONS SHOWN ARE FROM FACE OF CURB, UNLESS OTHERWISE NOTED.

<div><div><div>SDC</div><div>SITE DESIGN COLLABORATIVE</div></div><div>243 E. 3rd Street Long Beach, CA 90802</div><div>1333 W. McDermott Dr., Suite 200 Allen, TX 75013</div><div>JOB NO.: 20240719.0Firm # F-21415</div></div>				ARCH AIRPORT ROAD STREET IMPROVEMENTS				
				GENERAL NOTES				
REVISION NO.	DESCRIPTION	DATE	BY	APPRVD. BY	DEPARTMENT OF PUBLIC WORKS CITY OF STOCKTON, CALIFORNIA			
					SCALE:	AS NOTED	APPROVED BY: <div>DATE</div>	SHEET NO.
					DESIGNED BY:	BB		C-1.1
					DRAWN BY:	BB		OF 4 SHEETS
					CHECKED BY:	MK		
					RECORD DWG.:		CITY ENGINEER STOCKTON, CALIFORNIA	PROJECT NO.

C:\USERS\SDCBY\SDCOLLABORATIVE\NET(1)\FILES - DOCUMENTS\PROJECTS - SDC\20240719.0 - MAVERIK (STOCKTON, CA)\PRODUCED\CAD\SHEETS\OFFSITE\20240719 STOCKTON OFFSITE C-1.0 COVER SHEET.DWG

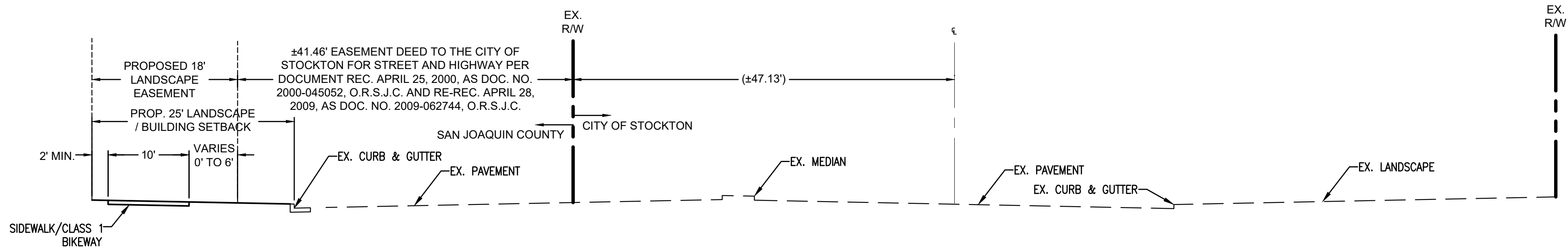

PROPOSED CROSS SECTION: ARCH AIRPORT ROAD
11+58.27 TO 15+47.54
16+06.95 TO 16+82.65
NOT TO SCALE



Know what's below.
Call before you dig.

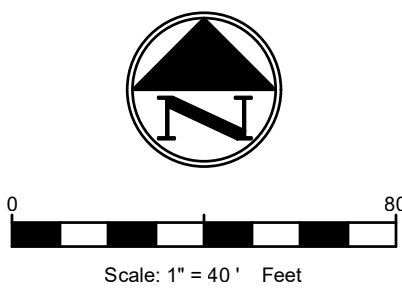

<div><div>SDC</div><div>SITE DESIGN COLLABORATIVE</div></div> <div>243 E. 3rd Street Long Beach, CA 90802 1333 W. McDermott Dr., Suite 200 Allen, TX 75013 Firm # F-21415</div> <div>JOB NO.: 20240719.0</div>				ARCH AIRPORT ROAD STREET IMPROVEMENTS		
				TYPICAL CROSS SECTION		
REVISION NO.	DESCRIPTION	DATE	BY	APPRVD. BY	DEPARTMENT OF PUBLIC WORKS CITY OF STOCKTON, CALIFORNIA	
					SCALE: AS NOTED	SHEET NO.
					DESIGNED BY: BB	C-2.0
					DRAWN BY: BB	OF 4 SHEETS
					CHECKED BY: MK	
					RECORD DWG.:	PROJECT NO.
					APPROVED BY: DATE	
					CITY ENGINEER STOCKTON, CALIFORNIA	

C:\USERS\SDCBY\SDCOLLABORATIVE\NET(1)\FILES - DOCUMENTS\PROJECTS - SDC\20240719.0 - MAVERIK (STOCKTON CA)\PRODUCED\CAD\SHEETS\OFFSITE\20240719 STOCKTON OFFSITE C-2.0 TYPICAL CROSS SECTIONS.DWG

- ① INSTALL R-1 STOP SIGN & STOP BAR
- ② CONSTRUCT 10'-WIDE MEANDERING SIDEWALK PER CITY OF STOCKTON STD. DWG. NO. R-19 & R-50
- ③ CONSTRUCT STANDARD COMMERCIAL DRIVEWAY PER CITY OF STOCKTON STD. DWG. NO. R-59
- ④ INSTALL BARRICADE PER CITY OF STOCKTON STD. DWG. NO. R-108
- ⑤ INSTALL R6-1(R) SIGN
- ⑥ PROPOSED SIDEWALK PER CITY OF STOCKTON STD. DWG. NO. R-50
- ⑦ PROPOSED RAMP PER CITY OF STOCKTON STD. DWG. NO. 5-59, DETAIL 1
- ⑧ INSTALL TYPE IV (R) THERMOPLASTIC PAVEMENT MARKING PER CALTRANS STD. PLAN A24A
- ⑨ INSTALL "RIGHT TURN ONLY" SIGN

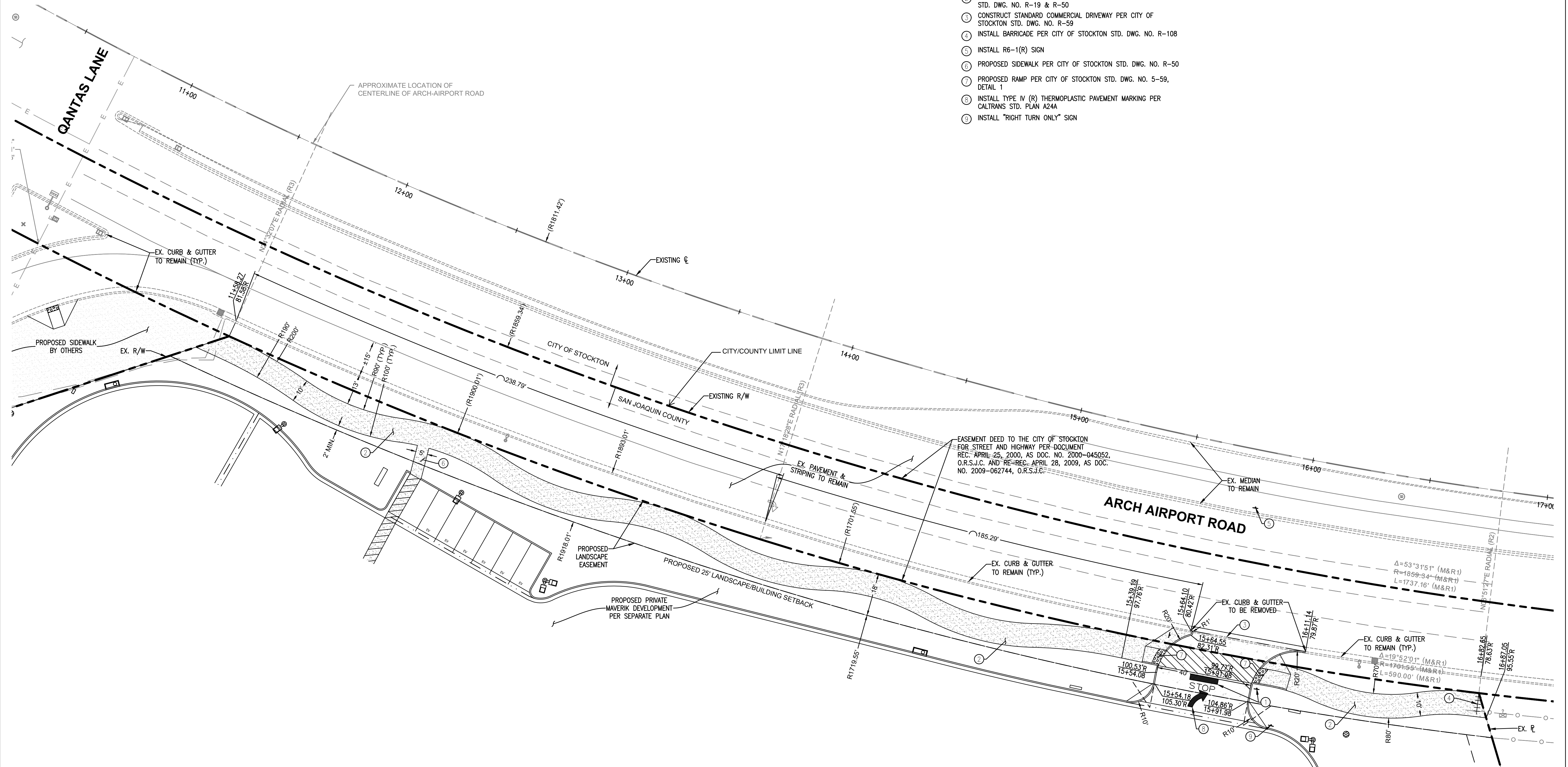

0



Scale: 1" = 40' Feet



Know what's **below**.
Call before you dig.

	243 E. 3rd Street Long Beach, CA 90802	ARCH AIRPORT ROAD STREET IMPROVEMENTS	
	1333 W. McDermott Dr., Suite 200 Allen, TX 75013 Firm # F-21415	CONSTRUCTION PLAN ARCH AIRPORT ROAD 11+58.27 TO 16+87.05	